

YSOFT SAFEQ™ ENTERPRISE SUITE



BENEFITS

- Centralized enterprise print management and advanced document capture and workflow
- Maximizes productivity, reduces costs and increases document security
- Flexible, module software means you pay only for features you need

With YSoft SafeQ Enterprise Print Management software, organizations have the tools needed to make fact-based decisions about their print environment to reduce print, copy and scan costs up to 30%, increase document security and improve productivity.

In a centralized print environment, a server application connects your multifunction devices (MFDs) or other networked printers to your corporate

directory. In this way, print administrators can implement pull-printing, set print governance policies and create efficient workflows for the capture, processing and distribution of digital content. See Figure 1.

YSoft SafeQ Enterprise Suite is the only enterprise-grade solution that truly integrates print management with document capture and workflow. While other solutions require multiple servers, contracts and help

desk systems to deliver both print management and document capture, which increases your total cost of ownership, Y Soft and YSoft SafeQ offer a seamless, integrated solution.

YSoft SafeQ is integrated within the display panel of the world's most popular MFD brands.

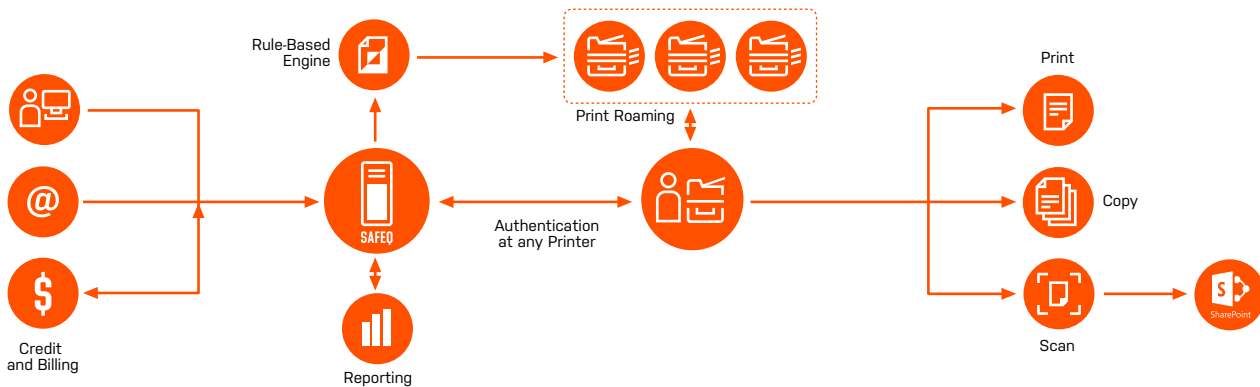

Figure 1. YSoft SafeQ User Workflow

"To point, pull-printing solutions (also known as follow-me, follow-you and print-release) grew from less than 5% or 10% of midsize and large-company MPS engagements in 2005, to more than half of the MPS engagements we have seen in 2015, and this, despite the license costs."

Gartner, Market Trends - Managed Content Services for the IT Side of Printing, Ken Weilerstein, September 2015, Doc #G00279020

"Thanks to the optimization of the print environment with YSoft SafeQ, we succeeded in lowering our costs for printing, copying and scanning by about 30%. And because we also replaced inefficient, old equipment with new MFDs, we will see more savings over the next five years. With these significant cost reductions, we expect to achieve ROI within two years."

Pavol Bonotka
Česká pojišťovna, a.s. (Czech insurance company)

MODULES	BENEFITS AT A GLANCE
<p>AUTHENTICATION</p>	<ul style="list-style-type: none"> • Protects against unauthorized users by securing access to MFD and documents • Documents remain secure until user authenticates via card reader, PIN, username/password or a combination • Reduces costs and paper waste when jobs are sent to print but are no longer needed • Easily assign print, copy and scan rights to users or user groups means easy IT administration
<p>RULE-BASED ENGINE</p> <p>Coming soon for document capture and workflow.</p>	<ul style="list-style-type: none"> • Enforces print governance with a library of pre-defined rules for cost savings such as color to B/W, single to double-sided and send to most economical device-or create your own rules • Notifications inform users of cost consequences which leads to better print usage, often reduced usage • Notifications if the user does not comply to cost savings policies help enforce print governance
<p>PRINT ROAMING® / CLIENT BASED PRINT ROAMING™</p>	<ul style="list-style-type: none"> • Secure printing from any MFD in the print environment without needing additional print drivers • Scalable to your business needs from one office to multiple continents • Jobs print only when user authenticates eliminating sensitive documents in output tray • Optionally, reduces costly servers by handling complex print tasks on client workstation

MODULES	BENEFITS AT A GLANCE
<p>MOBILE PRINT</p>	<ul style="list-style-type: none"> • YSoft Wireless Print for Mac and iOS mobile devices ensures convenient, secure printing for mobile workers • Secure mobile printing via web or email to the MFD • Support for anonymous guest printing • Provides automatic conversion (JPG, PDF, DOC, PPT, XLS, PNG)
<p>MANAGED WORKFLOWS: CORE AND ADVANCED WORKFLOWS</p>	<ul style="list-style-type: none"> • One-click secure scanning to pre-defined Microsoft SharePoint® and Dropbox® Business / Dropbox Enterprise document libraries makes document capture and distribution easy • Folder browsing, storing documents on behalf of user who made a scan for document storage under the MFD user's identity and barcode recognition • Scan to email, home folder or predetermined location via scripts • World-class OCR engine, image cleanup, append or prepend pages, blank page removal, highlight text naming and searchable PDF, Microsoft Word and Microsoft Excel
<p>CREDIT AND BILLING</p>	<ul style="list-style-type: none"> • Individual or group accounts make administrative tasks easier • Supports price lists, cost centers, billing codes and usage quotas for easy cost allocations • Support for pay-for-print services gives control for managing and recovering costs
<p>REPORTING</p>	<ul style="list-style-type: none"> • Predefined or custom management reports give fact-based data and usage audits • Executive and sustainability reports provide top level summarized results and sustainability information • CRS reports utilizing OLAP cubes and long term trend analysis help administrators manage their print fleet more efficiently

PRINT ROAMING & CLIENT BASED PRINT ROAMING

Print Roaming, also known as pull-printing, allows employees to send a print job and securely print it at any printer in the print environment – across the hall, in another building, across the country or on another continent.

Documents sent to be printed “follow” their owner to any MFD in the organization that is connected to the YSoft SafeQ system and that the employee is authorized to print from. One of the main benefits of the YSoft SafeQ architecture is supporting Print Roaming at any scale.

In this way, a user can send the print job from his home office and fly to another company location and be able to print from any printer at that location, without needing to install additional print drivers. See Figure 2.

YSoft SafeQ's architecture includes the use of high-performance, highly scalable YSoft SafeQ Site Servers which significantly reduce the number of servers needed to support high availability of print services. And, by connecting Site Servers into groups, YSoft SafeQ can easily scale to

accommodate additional printers or to increase system performance. To reduce server ownership costs even further, Client Based Print Roaming handles complex print tasks on the user's workstation so costly servers can be significantly reduced – typically 2-4 times few servers*.

Although servers are necessary for user experience, security and embedded terminal web services, they can be replaced with less expensive, lightweight appliances such as YSoft SafeQube 2. See Figure 3.

* The number of fewer servers may vary depending on your print volumes, number of devices and number of users

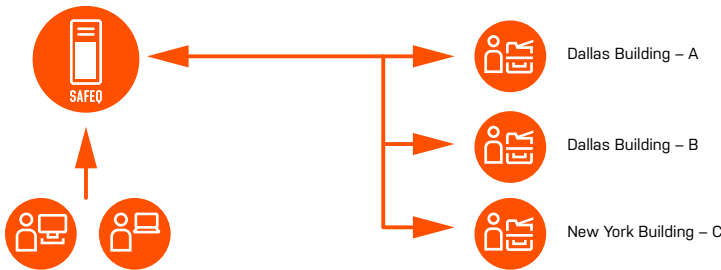

Figure 2. Print Roaming

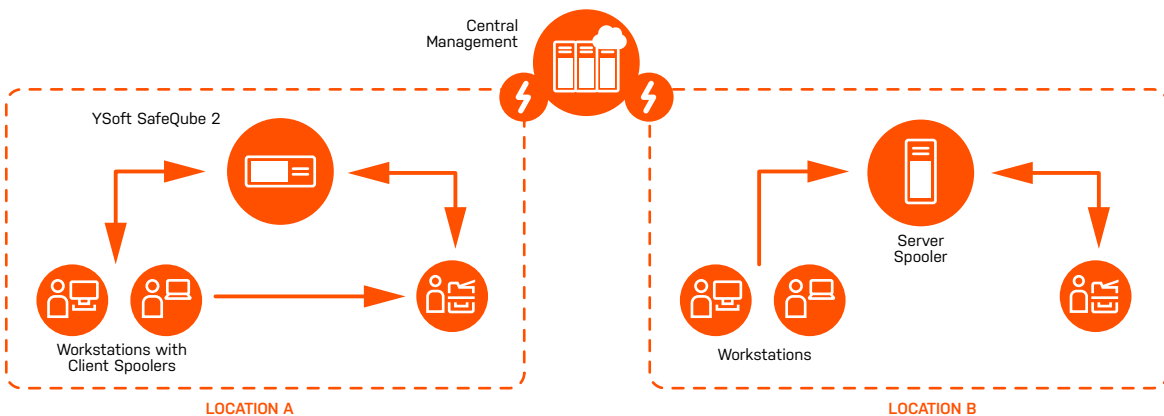
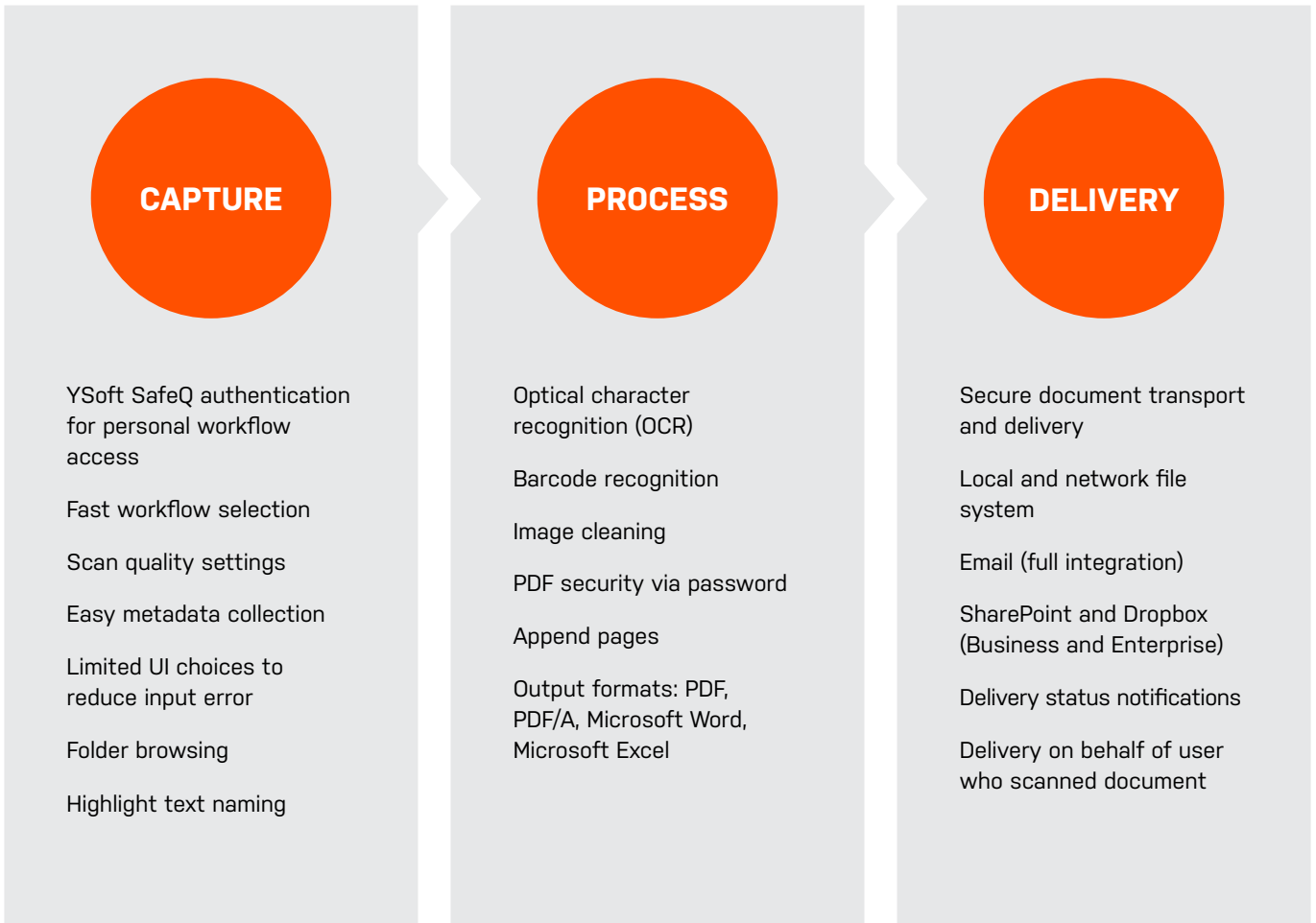

Figure 3. Client Based Print Roaming with optional YSoft SafeQube 2 appliance

TAKING THE COMPLEXITY OUT OF SCANNING

For many organizations, the promise of going digital goes unfulfilled because the creation of digital workflows is cumbersome and, for the user, finding the scan function and navigating through multiple menu options is confusing and frustrating. With YSoft SafeQ's Managed Workflow modules, the complexity of scanning for both administrators and users is eliminated.

KEY MANAGED WORKFLOW FEATURES



"38% of North American decision makers indicate implementation of document workflow software/solutions to be extremely important (must have) when selecting a managed print services provider."

Photizo Group Decision Maker Tracking Study, 2015, North America

"Improved accessibility, higher productivity, and faster response to customers are the biggest drivers for scanning and capture, along with reduction in office space. Automating more manual processes is the biggest priority for users, and 23% are looking to invest in better technology."

AllIM 2015 Market Report on Paper-Free Progress

ADMINISTRATOR WORKFLOW

Pre-defined templates make administrator setup simple and easy. YSoft SafeQ's reporting module provides fact-based details on the documents scanned by user, by group or by device as an audit trail on sensitive and confidential documents. See Figure 4.

ADMINISTRATOR

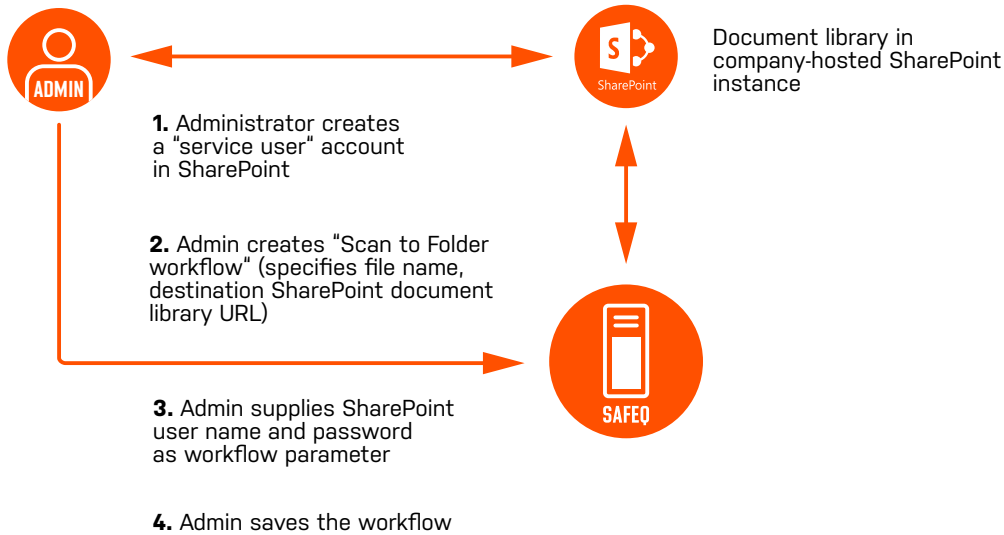

Figure 4. Administrator Workflow

USER WORKFLOW

Simple, intuitive screen guides users to approved scan functions and document destinations. See Figure 5 and 6.



Figure 5. Scan menu integrated into MFD panel.

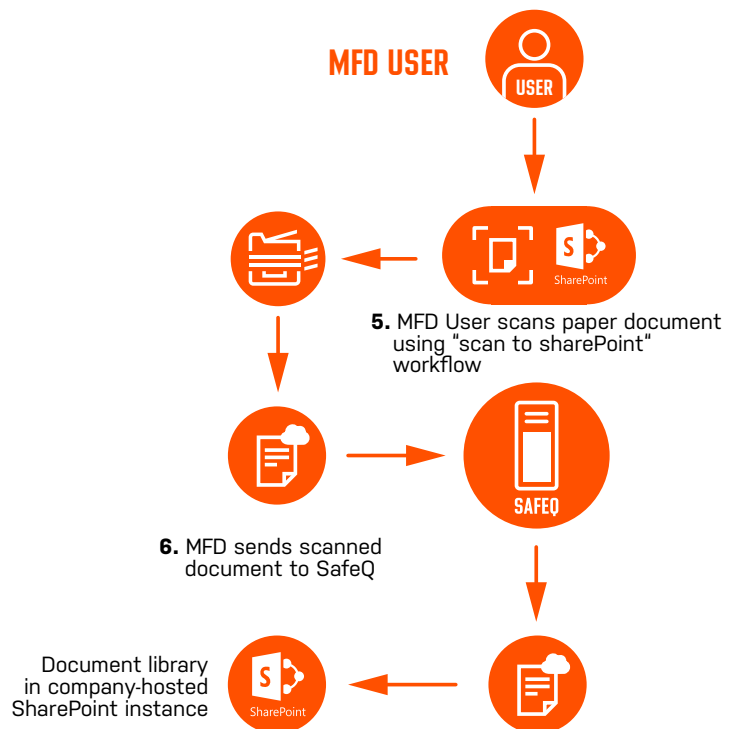

Figure 6. Simple workflow sends scans to pre-defined locations such as SharePoint or Dropbox.

Y SOFT COMPLEMENTARY SOLUTIONS

The YSoft SafeQ software solution can be utilized with optional, complementary hardware and software solutions. Y Soft designs, manufacturers and quality tests each hardware solution with YSoft SafeQ software. With a fully turnkey solution, organizations can be assured both hardware and software operate well together instead of building a solution from disparate systems and vendors that require different pricing, support and service contracts often resulting in a diverse user experience.

YSOFT SAFEQ TERMINAL PRO 4

When an integrated (embedded) solution is not desirable or not available, YSoft Terminal Pro 4 provides the interface for Authentication, Print Roaming and other functions. Y Soft offers a modern, touchscreen display with a built-in card reader slot.

YSOFT USB READER 3 AND AUTHENTICATION CARDS

Whether using an embedded solution or an external terminal, YSoft USB Reader 3 and Authentication Cards provide an easy swipe motion to authenticate at any MFD or networked device. Card Reader cables are available upon request.

YSOFT PAYMENT MACHINE

When used with YSoft SafeQ Credit and Billing module or YSoft be3D eDee, this optional self-service payment device allows users to add credit to their print services account by accepting coins and bills of the selected currency. YSoft Payment Machine is secured against theft and automatically sends a message to the administrator if tampering is detected.

YSOFT SAFEQUBE 2

Organizations looking to reduce their print services infrastructure can use YSoft SafeQube 2, a lightweight server alternative. Together with Client Based Print Roaming, complex print tasks are handled on the workstations, while SafeQube 2 is responsible for authenticating users and reporting to Central Management on local spooler activity – which are less data intensive tasks. YSoft SafeQube 2 also provides quicker user interface interactions and has less risk of being affected by network outages.

YSOFT SAFEQ MOBILE TERMINAL APP

For iOS and Android devices, the YSoft SafeQ Mobile Terminal app provides secure printing from smartphones and tablets. QR codes are used to identify an MFD or networked device that, when scanned by the mobile app, allow users to print and choose additional finishing options. The YSoft SafeQ Mobile Terminal app is also a cost-effective solution to enable YSoft SafeQ features on smaller printers or MFDs.

YSOFT BE3D EDEE

Specifically designed for education, YSoft be3D eDee is the first 3D printer with print management and an accounting system. When used with YSoft SafeQ Print Management Suite, educational institutions have one centralized print management and billing system across 2D and 3D printers. eDee allows educational institutions to manage the use and account for the costs of 3D printing by students and staff.

LOCATIONS

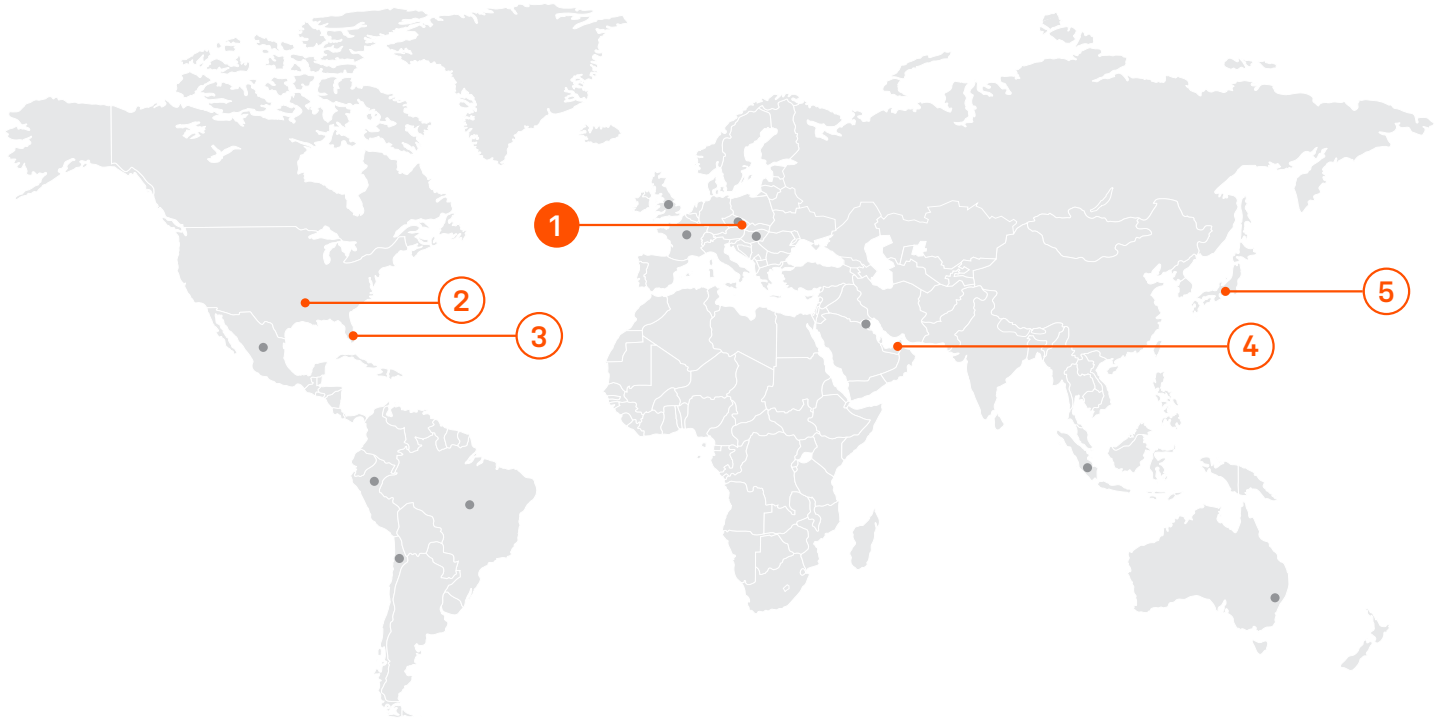

Company Headquarters	Regional Headquarters	
<p>1 Y Soft Corporation, a.s. Technology Park, Technická 2948/13 616 00 Brno Czech Republic</p>	<p>2 North America Y Soft North America, Inc. 1452 Hughes Rd, Suite 110 Grapevine, TX 76051</p> <p>3 Latin America Y Soft Latin America 2000 Ponce de Leon Blvd, Suite 652 Coral Gables, FL 33134</p>	<p>4 Middle East Y Soft Middle East Office 410, 4th Floor, Alfa Building Dubai Internet City, Dubai</p> <p>5 Asia Pacific Y Soft Japan, Ltd. KFM Building, 10th Floor 658-0032 Koyochō Higashinada Kobe, Hyogo Japan</p>

For a complete list of more than sixteen countries and locations, please visit our website.



© 2016 Y Soft Corporation, a.s. All rights reserved. Y Soft is a registered trademark of Y Soft Corporation, a.s. in the European Union and/or other countries. All other trademarks and/or registered trademarks are the property of their respective owners. Information is subject to change without notice.

SFQ-EP-EN-7-2016